

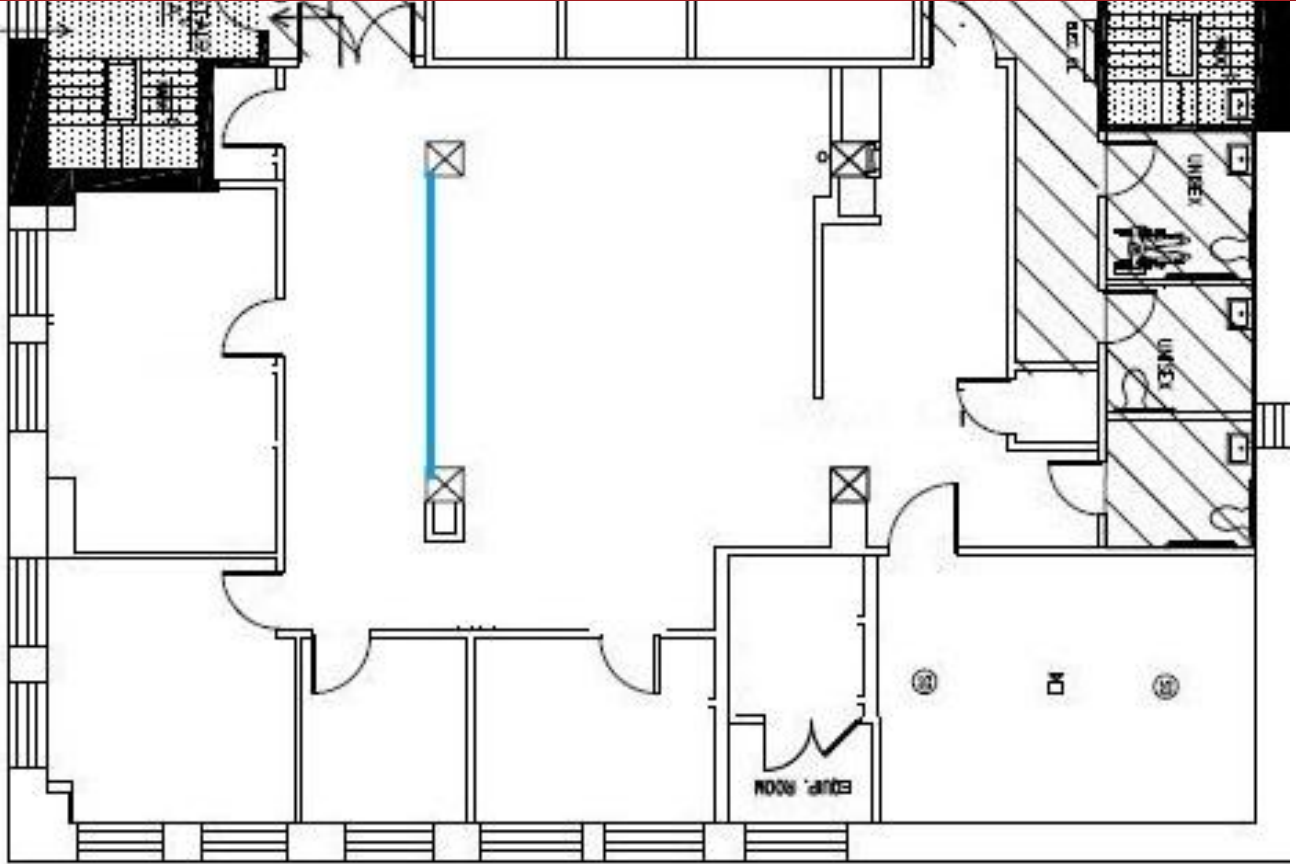

REDWOOD

PROPERTY GROUP



29 West 35th Street - Partial 6th Fl

Below Market Short Term Sublease through March 2021

Space: Partial 6th floor: 4,100 SF

Built as: Three windowed offices, corner conference room, two open areas, pantry, private bathroom

Finishes: Hardwood floors, exposed ceilings, operable windows, and glass finishes (one room has carpet and drop ceiling)

Centrally located: very convenient to N, Q, R, W, B, D, F, M, PATH. Also close to 1, 2, 3, 6 subways and walking distance from Penn Station and Grand Central

Notes:

- Corner w/ good light
- Relatively small building
- 24/7 tenant-controlled central air
- 24/7 attended lobby
- Very fast consent process



REDWOOD
PROPERTY GROUP

Conference Room + One Open Area





REDWOOD
PROPERTY GROUP

Two offices (excuse the mess in the bottom one)





Reception, pantry, and another office

